

# BROACHING UNIT FOR LATHES

## BENZ LINA 4.0 - RADIAL

### TECHNICAL DATA



Broaching machining



Actuating angle



Internal + external cooling



Star Turret

#### TYPE

**GS**

$i = 2:1$

**GSL**

$i = 2:1$

#### L1

**GS**

variable

**GSL**

variable

#### TOOL HOLDER



Prism tool holder  
 $\varnothing 30 \text{ mm}$

#### TURRET INTERFACE



VDI



BMT



CDI



More on request

**i.com**



For questions regarding BENZ i.com please contact our BENZ Sales Team.

#### Performance data

GS	$i$	EC / IC	IC $p_{\text{max}}$ [bar]	$n_{1 \text{ max}} / *n_{2 \text{ max}}$ [ $\text{min}^{-1}$ ]	$M_{1 \text{ max}} / F_{c \text{ max}}$ [Nm]	$f$ [mm]	**Groove width <sub>max</sub> [mm]
Usable working stroke = 32 mm	2:1	✓/✓	50	3000 / 1500	15 / 1700	0,02 - 0,10	12
Total Stroke = 34 mm							

\*double stroke per minute

\*\*depending on the material to be machined

#### Performance data

GSL	$i$	EC / IC	IC $p_{\text{max}}$ [bar]	$n_{1 \text{ max}} / *n_{2 \text{ max}}$ [ $\text{min}^{-1}$ ]	$M_{1 \text{ max}} / F_{c \text{ max}}$ [Nm]	$f$ [mm]	**Groove width <sub>max</sub> [mm]
Usable working stroke = 51 mm	2:1	✓/✓	50	2000 / 1000	23 / 1700	0,02 - 0,10	12
Total Stroke = 53 mm							

\*double stroke per minute

\*\*depending on the material to be machined

For more information about the product or to order please contact our BENZ Sales Team



please click here ▶

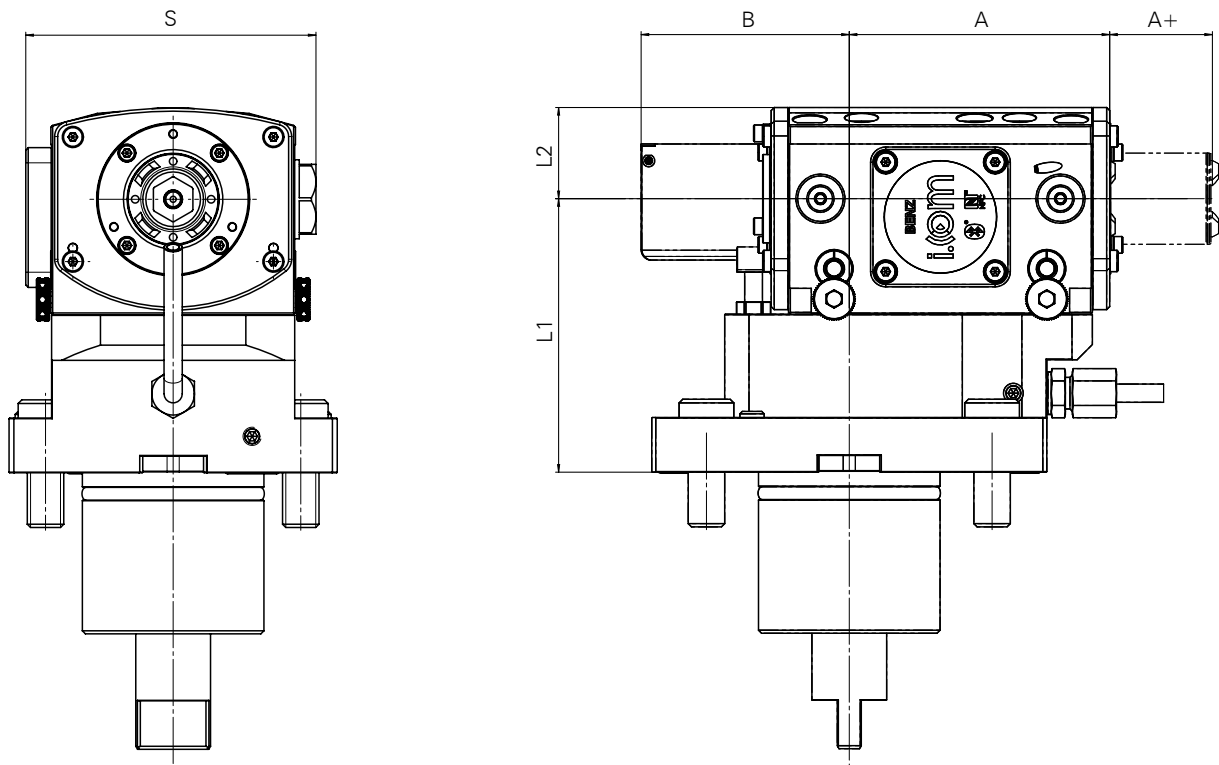

Technical Data

Typ	Size Plunger	**A+ [mm]	A [mm]	B [mm]	L1 [mm]	L2 [mm]	S [mm]	Weight [kg]*
GS	30	32 / 34	86,5	68,5	■	30	95,5	8-9
GSL	30	51 / 53	116,5	87,5	■	30	115,5	11-12

■ Dimension depends on machine geometry

\*varies based on base holder

\*\*usable working stroke / total stroke

PRODUCT INFORMATION



[www.benztooling.com/en](http://www.benztooling.com/en)